

IMPORTANT SAFETY INSTRUCTIONS

WHEN USING AN ELECTRICAL FURNISHING, BASIC PRECAUTIONS SHOULD ALWAYS BE FOLLOWED, INCLUDING THE FOLLOWING:

READ ALL INSTRUCTIONS BEFORE USING THIS FURNISHING.

DANGER — TO REDUCE THE RISK OF ELECTRIC SHOCK: ALWAYS UNPLUG THIS FURNISHING FROM THE ELECTRICAL OUTLET BEFORE CLEANING.

WARNING — TO REDUCE THE RISK OF BURNS, FIRE, ELECTRIC SHOCK OR INJURY TO PERSONS:

1. Unplug from outlet before putting on or taking off parts.
2. Close supervision is necessary when this furnishing is used by or near children, invalids, or disabled persons.
3. Use this furnishing only for its intended use as described in these instructions. Do not use attachments not recommended by the manufacturer.
4. Never operate this furnishing if it has a damaged cord or plug, if it is not working properly, if it has been dropped or damaged, or dropped into water. Return the furnishing to a Service Center for examination and repair.
5. Keep the cord away from heated surfaces.
6. Never drop or insert any object into any opening.
7. Do not use outdoors.

8. Do not operate where aerosol (spray) products are being used or where oxygen is being administered.
9. To disconnect, turn all controls to the "0" position, then remove plug from outlet.
10. Do not leave appliance unattended when it is plugged in.
11. Be sure mirror is not in a position where it can reflect sunlight; reflected sunlight can cause fire.
12. Do not use on a soft surface such as a bed, where openings may be blocked.
13. Never operate the furnishing with the air openings blocked. Keep the air openings free of lint, hair and the like.
14. Turn switch to "0" position, allow unit to cool and unplug cord before replacing light bulbs.
15. Do not place or store appliance where it can fall or be pulled into a tub or sink.
16. If an appliance falls into water, unplug it immediately. Do not reach into the water.
17. To protect against electrical hazards, do not use while bathing or in the shower.
18. Never use while sleeping.
19. Do not use a bulb greater than 10 watts.
20. Use on any 120 volt 60 hertz AC electric outlet (ordinary house current). Do not use on any other electrical outlet.

FOR HOUSEHOLD USE ONLY
SAVE THESE INSTRUCTIONS

OPERATING INSTRUCTIONS

To reduce the risk of electric shock, this mirror has a polarized plug (one blade is wider than the other). This plug will fit in a polarized outlet only one way. If the plug does not fit fully in the outlet, reverse the plug. If it still does not fit, contact a qualified electrician to install the proper outlet. Never use with an extension cord unless plug can be fully inserted. Do not change the plug in any way.

CAUTION: be sure direct sunlight does not strike mirror when left unattended; reflected sunlight can cause fire.

1. Your lighted makeup mirror will adjust to different angles. Simply tilt the mirror housing back and place the metal brace in the desired slot on the bar.
2. Take the plug and insert into any standard wall outlet (120 Volt AC).
3. To turn on lights, simply turn dial on base to desired light setting.
4. After use turn dial to "0", unplug and store mirror in a safe location.

SPECIAL FEATURES

This lighted makeup mirror uses incandescent light bulbs with special coating, reproducing shadow-free lighting in four different settings: Evening, day, home and office

REPLACEMENT BULBS

CAUTION: TURN OFF POWER AND UNPLUG, ALLOW TO COOL AT LEAST 3 MINUTES BEFORE REPLACING BULB.

1. Unplug your lighted mirror.
2. Open the doors and look for the thumb indentation in the middle of each lens (the cover over the light bulbs).
3. With a coin or the tip of a screwdriver, carefully lift up the lens.
4. Reach in and unscrew the used light bulb and replace it with a light bulb of the same color (blue bulbs on top, white bulbs on the bottom).
5. Slide the lens back into position and snap it closed (the snaps are located in the upper and the lower third of the lens). Close the doors.
6. Now you can plug your mirror back in. It is ready for use.

GET TO KNOW YOUR LIGHTED MAKEUP MIRROR

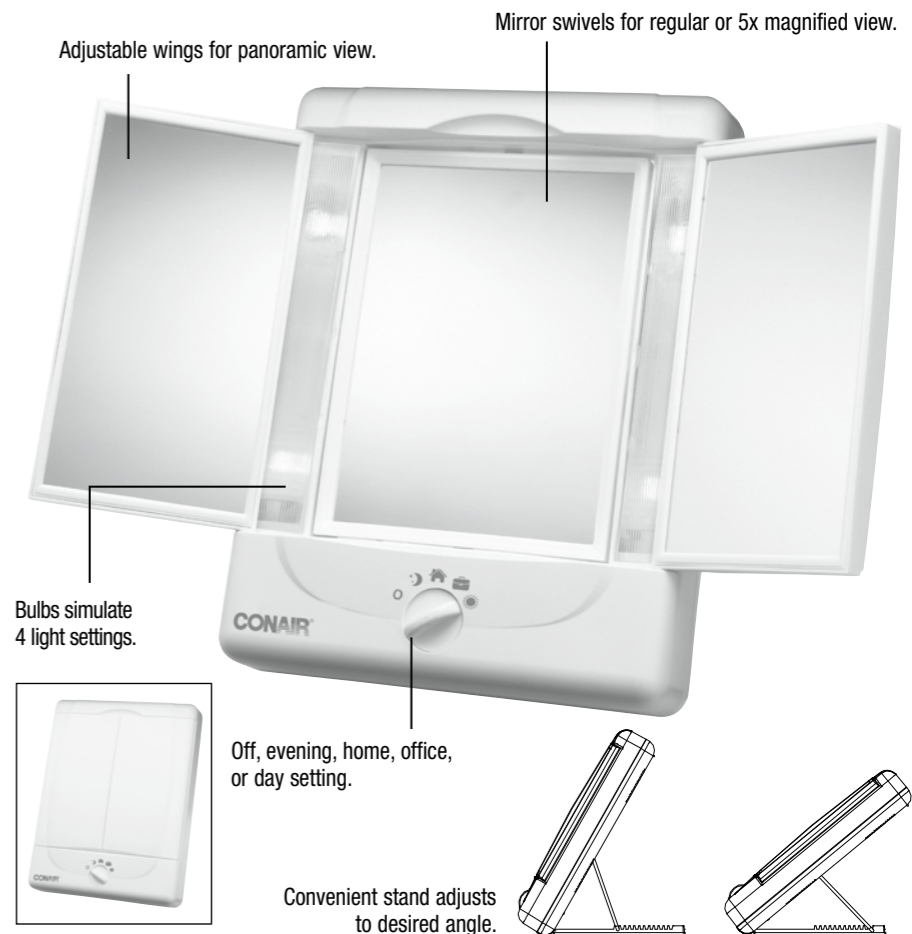

MAINTENANCE

Your lighted mirror is designed for household use, and is virtually maintenance-free. No lubrication is needed. If cleaning becomes necessary, disconnect the appliance from the power source and wipe exterior with a damp cloth. Clean mirror surfaces with a glass cleaner. If any abnormal condition occurs, unplug the lighted mirror, allow it to cool, and return it to an authorized service representative for repair.

STORAGE

If mirror is not in use, disconnect from electrical outlet. **BE SURE DIRECT SUNLIGHT WILL NOT STRIKE MIRROR WHEN LEFT UNATTENDED;** reflected sunlight may cause fire. Allow to cool to room temperature before storing. Place in cool, dry area out of reach of children, and where it will not be damaged. Handle cord carefully for longer life. Do not jerk or strain at plug connections or wrap cord around mirror for storage. This could cause the cord to become damaged and short-circuit. To store mirror coil cord loosely, starting at the appliance, and place cord in large loops next to mirror or secure cord with a twist tie.

CAUTION: TO PREVENT ELECTRIC SHOCK, MATCH WIDE BLADE OF PLUG TO WIDE SLOT, FULLY INSERT.

CAUTION: RISK OF FIRE, USE ONLY 10 WATTS MAXIMUM 120 VOLT, TYPE T BULBS.

DISCONNECTED FROM THE SUPPLY CIRCUIT BEFORE SERVICING OR CLEANING. DO NOT SUBMERSE.

**MODEL: TGTM7LXC
RATING: 120V AC 60HZ 40W, 0.33A
DATE CODE:**

**WARNING:
IF YOU THINK
THE POWER IS
OFF WHEN THE
SWITCH IS OFF,
YOU'RE WRONG.**

**KEEP AWAY FROM
WATER**

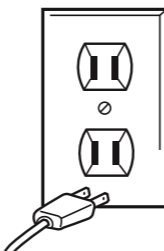

Everyone knows that electricity and water are a dangerous combination. But did you know that an electric appliance is still electrically live even if the switch is off? If the plug is in, the power is on. So when you are not using your appliances, keep them unplugged.

**ALWAYS UNPLUG
SMALL APPLIANCES**

LIMITED ONE YEAR WARRANTY

Conair will repair or replace (at our option) your unit free of charge for 12 months from the date of purchase if the appliance is defective in workmanship or materials. To obtain service under this warranty, return the defective product to the service centre listed below, together with your purchase receipt and \$7.50 for postage and handling. In the absence of a purchase receipt, the warranty period shall be 12 months from the date of manufacture.

ANY IMPLIED WARRANTIES, OBLIGATIONS, OR LIABILITIES, INCLUDING BUT NOT LIMITED TO THE IMPLIED WARRANTY OF MERCHANTABILITY AND FITNESS FOR A PARTICULAR PURPOSE, SHALL BE LIMITED IN DURATION TO THE 12 MONTH DURATION OF THIS WRITTEN, LIMITED WARRANTY.

IN NO EVENT SHALL CONAIR BE LIABLE FOR ANY SPECIAL, INCIDENTAL, OR CONSEQUENTIAL DAMAGES FOR BREACH OF THIS OR ANY OTHER WARRANTY, EXPRESS OR IMPLIED, WHATSOEVER.

This warranty gives you specific legal rights, and you may also have other rights, which vary from province to province.

SERVICE CENTRE

©2015 CONAIR CONSUMER PRODUCTS ULC
100 Conair Parkway
Woodbridge Ontario, L4H 0L2
For more information on any Conair product call:
1-855-926-6247
Visit our Web site:
www.conaircanada.ca
Consumer Call Centre E-mail:
Consumer_Canada@Conair.com

15CN148116

IB-13655

renew · refresh · revive

true glow™

Soft halo lighting mirror for a gentle glow.



Have a Question?

Please do not return this product to the retailer.

Call Us First!

Our customer service and product experts are ready to answer ALL your questions.

Please call our TOLL-FREE customer service number at: 1-855-926-6247 or visit us online at www.conaircanada.ca

Instruction & Styling Guide

Model TGTM7LXC